

HYDRAULIC EXCAVATOR **SY135C**



SANY
GERMANY

ENGINE ISUZU AJ-4JJ1X
POWER 73 KW /2000 RPM
OPERATING WEIGHT 13,800 KG
GROUND PRESSURE 41.7 KPA
BUCKET CAPACITY 0.53 M³

RELIABLE FIRST-CLASS COMPONENTS 08

Guaranteeing easiest and most versatile operation in every working environment. A structure that keeps all promises.

LOWER FUEL CONSUMPTION 04 | 05

With perfectly aligned engine and hydraulics.

OPTIMIZED CABIN 06 | 07

For highest visibility and maximum comfort.

INSTRUMENT OF PERFORMANCE.

QUALITY CHANGES THE WORLD

The SY135C is one of five excavator models developed for the European market, meeting the highest customer requirements and needs. The reliable structure and improved stability enables the operator to fully concentrate on his work, whilst operating in a safe and efficient manner.

SIMPLIFIED SERVICE 09

Is a key tool for more uptime and reduced cost.



ISUZU AJ-4JJ1X STAGE/TIER III

The power for SY135C comes from an Isuzu four-cylinder four-stroke direct-injection turbocharger diesel engine, featuring a high-precision filter system and an auto deceleration system. With Stage/Tier III emission standards, the engine follows the environmentally friendly direction of SANY products.

INNOVATIVE ELECTRO-HYDRAULIC CONTROL SYSTEM

With a dual-pump, dual-circuit constant power control system, the engine can fully develop its power to provide a strong operating force. Optimized operation performance of the engine reduces the loss of power.

Through the electrical control (ESS control), the engine speed monitoring and power limit regulation as well as the hydraulic control (HSS control), the engine can have a real-time power match with the hydraulic pumps, improving operational productivity and reducing fuel consumption.

An advanced computer dynamic control system (CDCS) determines engine output power as per the external load demand, achieving the optimum control of excavator – external load operation system.

WHERE EFFICIENCY MEETS ECONOMICAL NEEDS.

Equipped with an Isuzu AJ-4JJ1X engine and improved hydraulic systems, this machine performs at the peak of efficiency. An automatic deceleration system facilitates fuel savings of 5-10% as it brings the engine down to idle mode after 3.5 seconds, after operations stop. With the Isuzu diesel engine with Stage/Tier III Emission Standards, SANY is conscious of the environmental responsibility to reduce emissions and fuel consumption.

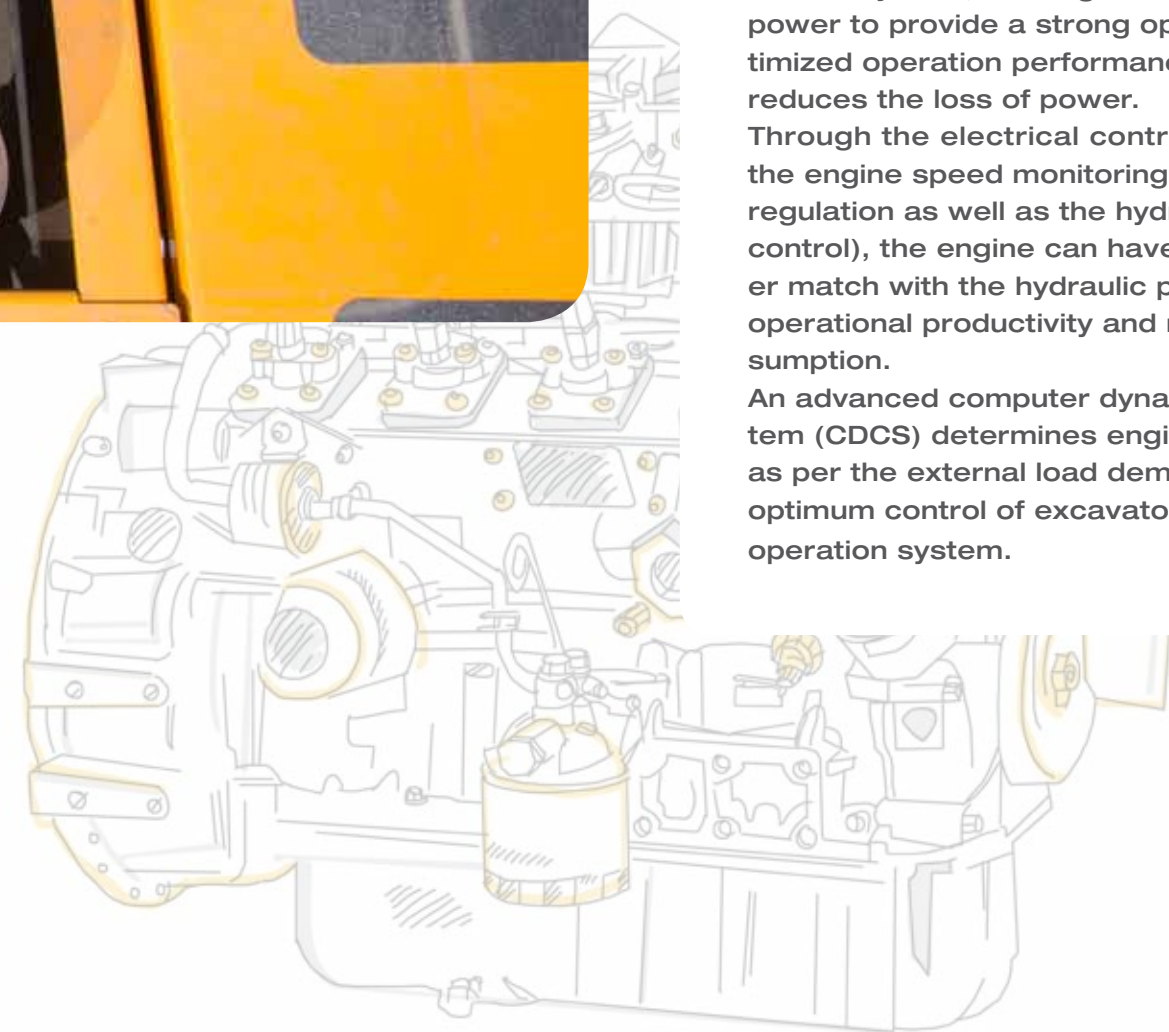



ROOM WITH A VIEW
Vision for safe operation.

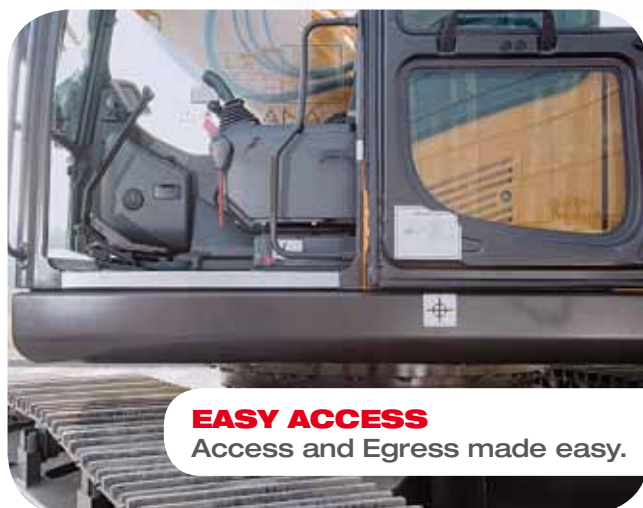

EASY ACCESS
Access and Egress made easy.



HIGH TECH
Control at your fingertips.



THE PLACE TO BE.

ERGONOMIC AND COMFORTABLE WITH LOW CABIN NOISE

SANY's optimized cabin enables an all-round visibility and is designed to support the operator's natural range of action. Spacious leg room and an adjustable seat are at the center of comfort, supporting an excellent working environment and increased productivity.



TOP PERFORMER
in all conditions.

A STRUCTURE THAT KEEPS ALL PROMISES.

SANY Hydraulic Excavators are designed and developed to perform in the toughest working conditions. A robot welding process ensures the precise production of a strong and durable machine. In intensive testing sequences, the products have to pass rigorous test procedures and prove their reliability, durability and longevity before being delivered to the customer.

UNDERCARRIAGE

X-beam design, using a box-section structure with high strength and durability, provide excellent torsion and bending resistant performance. Track rollers, carrier rollers and idlers have seal-in lubrication that provides a higher longevity as well as lower noise level.

REINFORCED BOOM AND ARM

The structure of the boom and arm of SY135C has been totally redesigned. With the emphasis on reducing stress points to a minimum, both boom and arm go through rigorous fatigue and field testing. With this, SANY has the confidence to apply their machines in any demanding working environment.

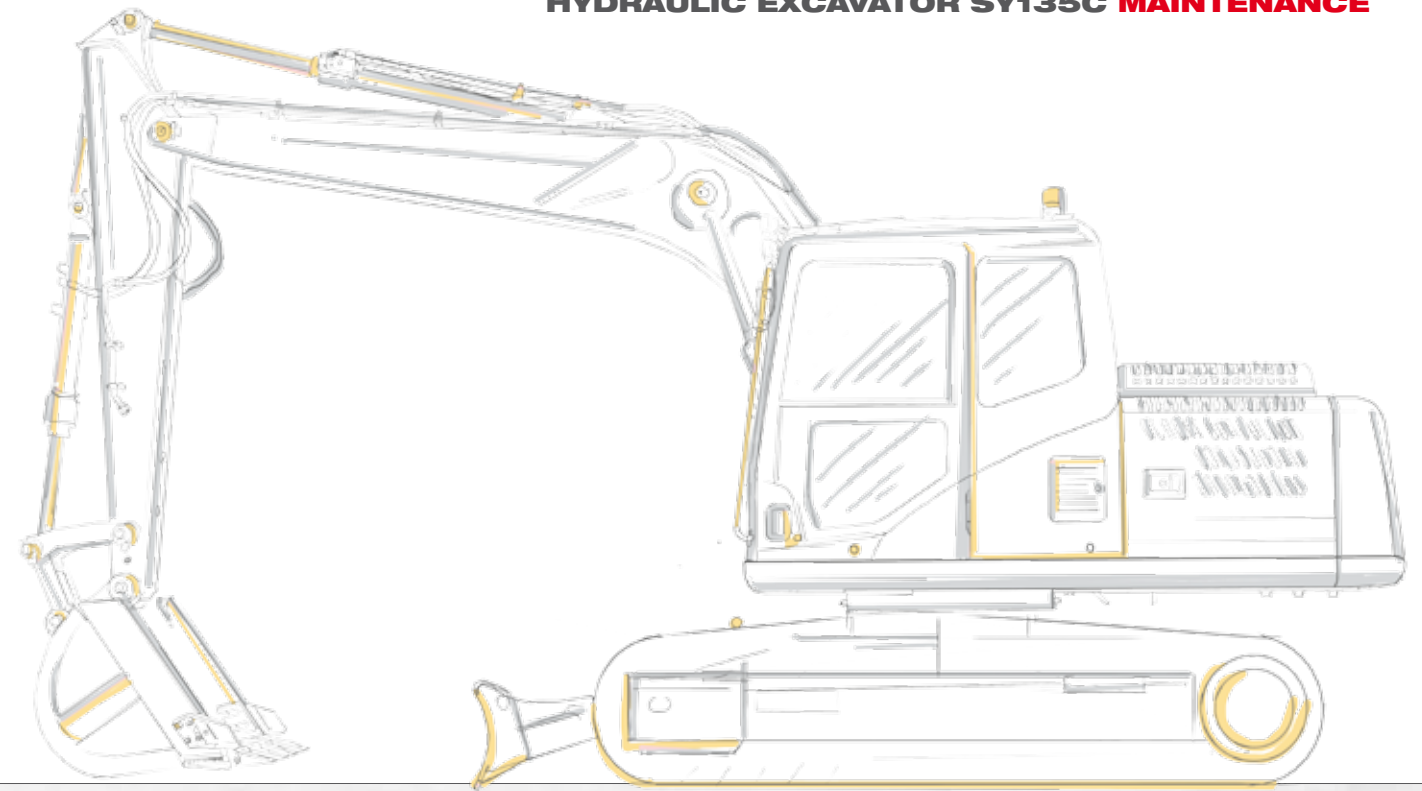

SIMPLIFIED SERVICEABILITY
with ground level doors.



THE EASE OF MAINTENANCE.

Comfort and safety of the operator are attributes that SANY places a lot of emphasis on, always aiming at creating the optimum working atmosphere for the customer. Simplified maintenance and service of SANY's Hydraulic Excavator has an effective impact on reduced time and cost. The design of SY135C allows you to safely service from ground level. The grouped filters are accessible with only one door.

42

Spareparts

40

38

36

34

32

30

28

26

YOUR VALUE IS OUR COMMITMENT.

VALUE PLUS

SANY offers customized services and products to fulfill highest demands. We understand value as our commitment to you which we aim to reflect in everything we do.



- European R&D
- First Class After Sales Support
- Best return on investment
- Fast and customized solutions
- Premium distribution network
- Selected and market proven components
- Continuous improvement and development
- Quality driven production processes
- Manufacturing expertise
- Deep Industry knowledge
- Commitment to environmentally friendly and safe solutions

HYDRAULIC EXCAVATOR SY135C SERVICE

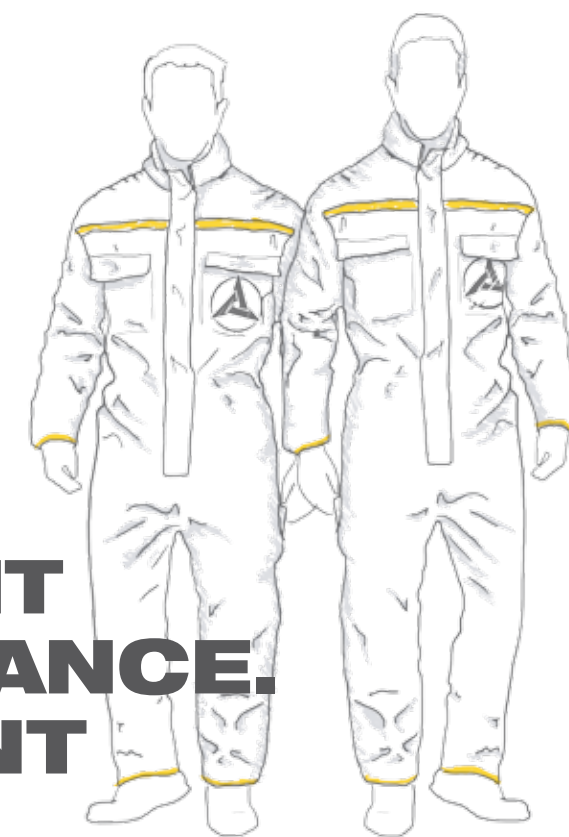

EXCELLENT PERFORMANCE. EXCELLENT SUPPORT.

The purchase of your SANY Excavator SY135C is just the beginning of a close relationship with SANY and its authorized dealers. SANY Germany understands the importance of an excellent After Sales Support to the customer, the organization is committed to minimize down-time and maximize the value of the products. SANY Germany's dealers are carefully selected and trained to provide the best Aftersales service in the container handling machinery sector. Their service teams are there to support you, anytime, anywhere your SANY equipment is working. SANY Germany is backing up all service partners with a huge parts inventory in Germany, ensuring parts availability and short lead times. Employing most modern communication and administration systems, SANY allows an easy approach to address any request our customers have. SANY provides space for individual solutions and strives to grow with its customers' businesses.



SPECIFICATIONS

| ENGINE | |
|--|----------------|
| Model | Isuzu AJ-4JJ1X |
| Displacement (l) | 2.999 |
| Engine power at rated engine speed (kW/ rpm) | 73/2000 |
| Max. Torque (N-M @ rpm) | 378/1600 |

| HYDRAULIC SYSTEM | |
|--|--|
| Type | Positive control system |
| Number of selectable working modes | 4 |
| Main pump | |
| Type | Variable-capacity piston pumps |
| Maximum flow (l/min) | 2*121 |
| Hydraulic motors | |
| Travel | 2* axial piston motor with parking brake |
| Swing | 1* axial piston motor with swing holding |
| Relief valve setting | |
| Implement circuits | 31.3mpa 306kg/cm² 4,539psi |
| Travel circuit | 34.3mpa 336kg/cm² 4,974psi |
| Swing circuit | 25mpa 245kg/cm² 3,625psi |
| Heavy lift circuit | 31.3mpa 306kg/cm² 4,539psi |
| Pilot circuit | 3.9mpa 38kg/cm² 565psi |
| Hydraulic cylinders | |
| Boom cylinder diameter x stroke (mm) | 105*990 |
| Arm cylinder diameter x stroke (mm) | 115*1175 |
| Bucket cylinder diameter x stroke (mm) | 100*885 |
| Blade cylinder diameter x stroke (mm) | 130*145 |

| SERVICE REFILL CAPACITIES (l) | |
|-------------------------------|------|
| Fuel tank | 240 |
| Engine coolant | 22 |
| Engine oil | 13.2 |
| Swing drive | 3 |
| Final drive (each side) | 2.6 |
| Hydraulic oil tank | 150 |

| OPERATING WEIGHT | |
|--|---------|
| Operating weight with standard bucket, fully serviced, +75 kg operator (ISO) | |
| Operating weight (kg) | 13875kg |
| Ground Pressure (kPa) | 41.7kpa |

| Drive | |
|--------------------------------|----------|
| Travel Speed (Low/High) (km/h) | 3.5/ 5.5 |
| Maximum Travel Force (kN) | 110 |
| Gradeability | 70%/35° |

| Swing | |
|-------------------|----|
| Swing Speed (rpm) | 12 |

| Digging Force | |
|---------------------------|----|
| Bucket Digging Force (kN) | 92 |
| Arm Digging Force (kN) | 66 |

DIMENSIONS

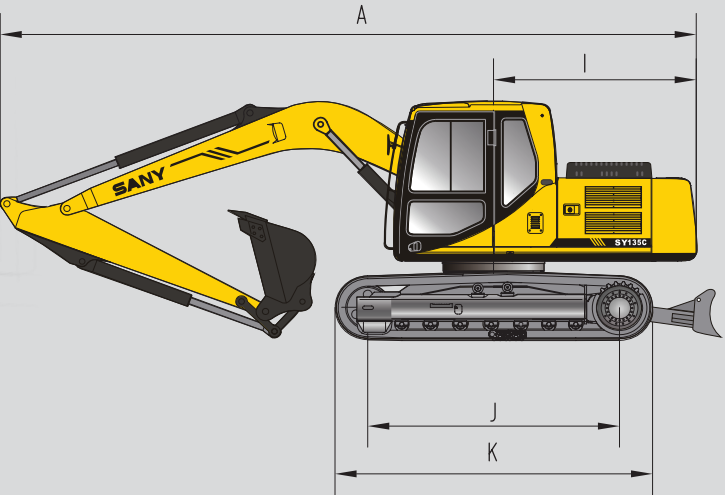

| ITEM | mm |
|------------------------------|------|
| A Transport Length | 7700 |
| B Transport Width | 2550 |
| C Transport Height | 2815 |
| D Upperstructure Width | 2490 |
| E Blade Height | 471 |
| F Standard Track Shoe Width | 600 |
| G Track Gauge | 1990 |
| H Minimum Ground Clearance | 425 |
| I Tail Swing Radius | 2205 |
| J Center distance of tumbler | 2930 |
| K Overall length of crawler | 3665 |
| Boom Length | 4600 |
| Arm Length | 2500 |

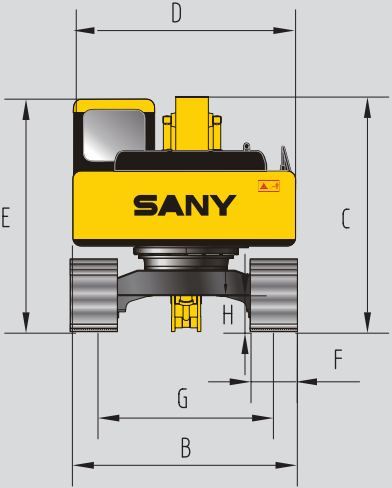

| UNDERCARRIAGE | |
|----------------------------------|-----|
| Track shoe width (mm) | 600 |
| Number of track shoes (per side) | 44 |
| Carrier roller (per side) | 2 |
| Track roller (per side) | 7 |

| ITEM | mm |
|-------------------------------|------|
| A Max. Digging Height | 8645 |
| B Max. Dumping Height | 6175 |
| C Max. Digging Depth | 5500 |
| D Max. Vertical Digging depth | 4850 |
| E Max. Digging Reach | 8290 |
| F Min. Swing Radius | 2500 |
| G Height at Min. Swing Radius | 6500 |

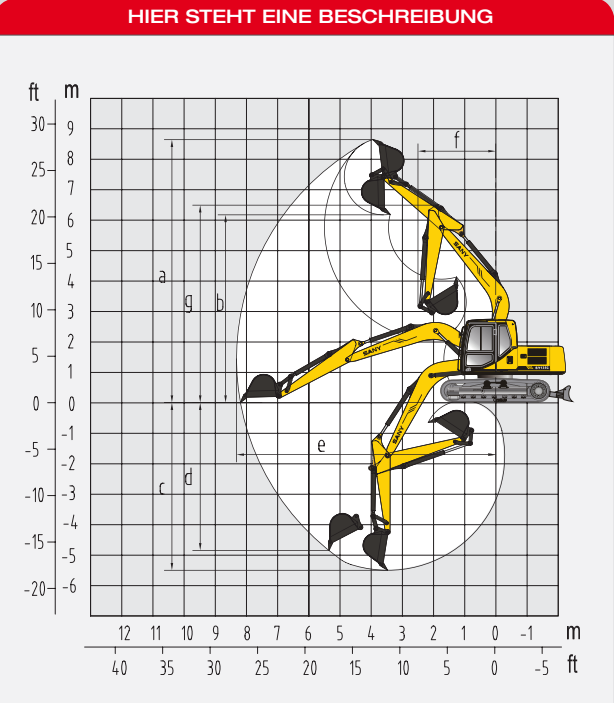

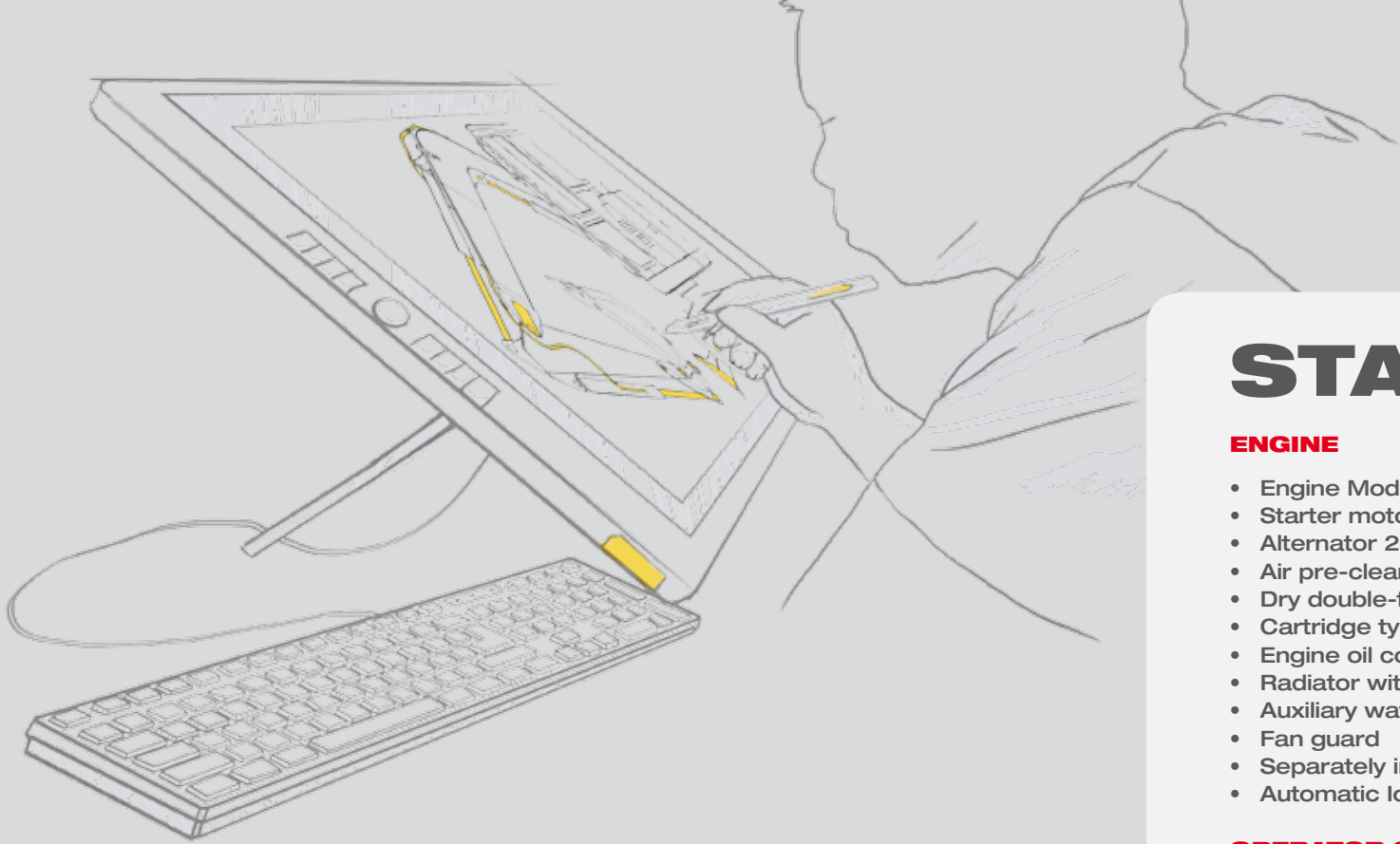





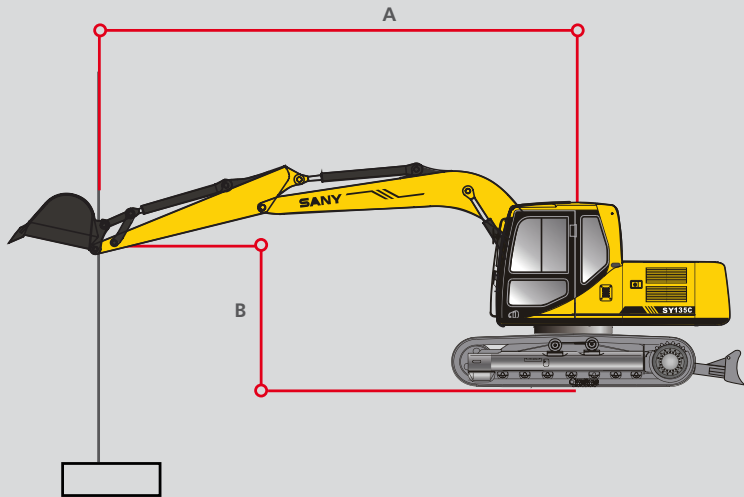

LIFTING CAPACITY

Arm Length: 1622mm

 Rating Over Side

 Rating Over Front



| A \ B | 6.0m | | 4.5m | | 3.0m | |
|-------|---|---|---|---|---|---|
| |  |  |  |  |  |  |
| 6.0m | / | / | *2650 | 2050 | / | / |
| 3.0m | 1750 | 1250 | 2600 | 1900 | 4250 | 3250 |
| 0m | 1650 | 1100 | 2350 | 1650 | 3800 | 2800 |
| -3.0m | 1650 | 1100 | 2650 | 1650 | | 2550 |

STANDARD EQUIPMENT

ENGINE

- Engine Mode control (H, S, L and B)
- Starter motor 24V/5KW
- Alternator 24V/50A
- Air pre-cleaner
- Dry double-filtering air cleaner
- Cartridge type engine oil filter
- Engine oil cooler
- Radiator with protective screen
- Auxiliary water tank for radiator
- Fan guard
- Separately installed engine
- Automatic Idle system

OPERATOR STATION

- ROPS compliant cab
- Noise proof steel-structured cab
- Laminated glass
- 6 silicone rubber damping support
- Openable roof hatch, upper front Window and left window
- Rear window escape exit
- Window wiper with washer
- Adjustable inclined seat with adjustable armrest
- AM-FM radio with digital clock
- Foot rest and floor mat
- 2 speakers
- Rear view mirror
- Seat belt
- Cup holder and Ashtray
- Cab light
- Storage box, literature bag
- Hydraulic lockout control
- Fully automatic air-conditioner
- Cab visor
- 12 v socket

HYDRAULIC SYSTEM

- Working mode selection switch
- Control valve with main relief valve
- Spare oil port for control valve
- Oil suction filter
- Oil return filter
- Pilot filter
- Hose rupture valve boom
- Hose rupture valve arm

UNDERCARRIAGE

- Travel brake
- Travel motor guard
- H-track guiding mechanism

- Hydraulic track tensioner
- Bolted sprocket
- Double carrier roller and track roller
- Reinforced track link with pin and seal
- 600 mm track shoe
- Bottom cover plate

SWING PLATFORM

- Hydraulic oil level gauge
- Toolbox
- Rear view mirror (R and L)
- Swing brake
- Counterweight

FRONT WORK EQUIPMENT

- Flanged pin
- Bucket clearance adjustment
- Welded bucket link
- Central lubrication point
- Dust ring-seal of bucket pin
- 4.6 m fully-welded box boom
- 2.5 m fully-welded box arm
- 0.53m³ standard bucket

ALARM & INDICATOR LIGHTS

- Engine oil pressure
- Engine coolant temperature
- Fuel low level
- Voltage higher than specification
- Engine over speed
- Auto-idle engine warm up
- Hi/Lo speed
- Throttle position fault
- Overload Warning Device

MONITORING SYSTEM

- Hour meter
- Fuel tank level gauge
- Engine coolant thermometer
- Engine oil pressure gauge

OTHERS

- Standard battery
- Lockable engine hood
- Lockable fuel filler cap
- Anti-skid film
- Handrail walkway
- Travel direction mark
- Hand grease gun

ADDR Sany Germany GmbH
Sany Allee 1, D-50181 Bedburg
TEL 0049 2272 90531 100
FAX 0049 2272 90531 109
MAIL info@sany-germany.de
NET www.sany-germany.de

Not all products are available in all markets. Under our policy of continuous improvement, we reserve the right to change specifications and design without prior notice. The illustrations do not necessarily show the standard version of the machine.